



119 W. Hayden Lake Road E  
 Champlin, MN 55316  
 (763) 712-0118

ChamplinLIFE@ChamplinSeniorLiving.com

[ChamplinSeniorLiving.com](http://ChamplinSeniorLiving.com)

# Assisted Living Two Bedroom E

Approx. 751 sq.ft.

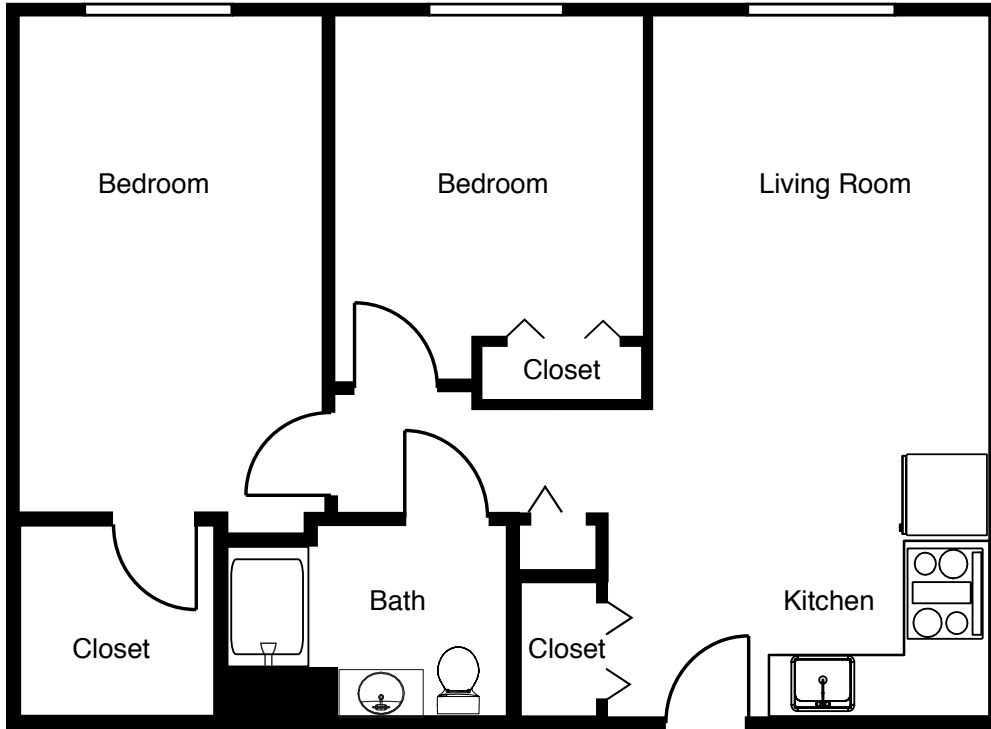

Date \_\_\_\_\_ Residence # \_\_\_\_\_ By \_\_\_\_\_

|                      |          |                            |          |
|----------------------|----------|----------------------------|----------|
| <b>Community Fee</b> | \$ _____ | <b>Monthly Fee</b>         | \$ _____ |
| Deposit              | \$ _____ | 2nd Person Fee             | \$ _____ |
| Other _____          | \$ _____ | Other _____                | \$ _____ |
| Total \$ _____       |          | Total Monthly Fee \$ _____ |          |

Dimensions are approximate.  
 Floor plans may vary.