



119 W. Hayden Lake Road E
 Champlin, MN 55316
 (763) 712-0118

ChamplinLIFE@ChamplinSeniorLiving.com

ChamplinSeniorLiving.com

Assisted Living One Bedroom B

Approx. 702 sq.ft.

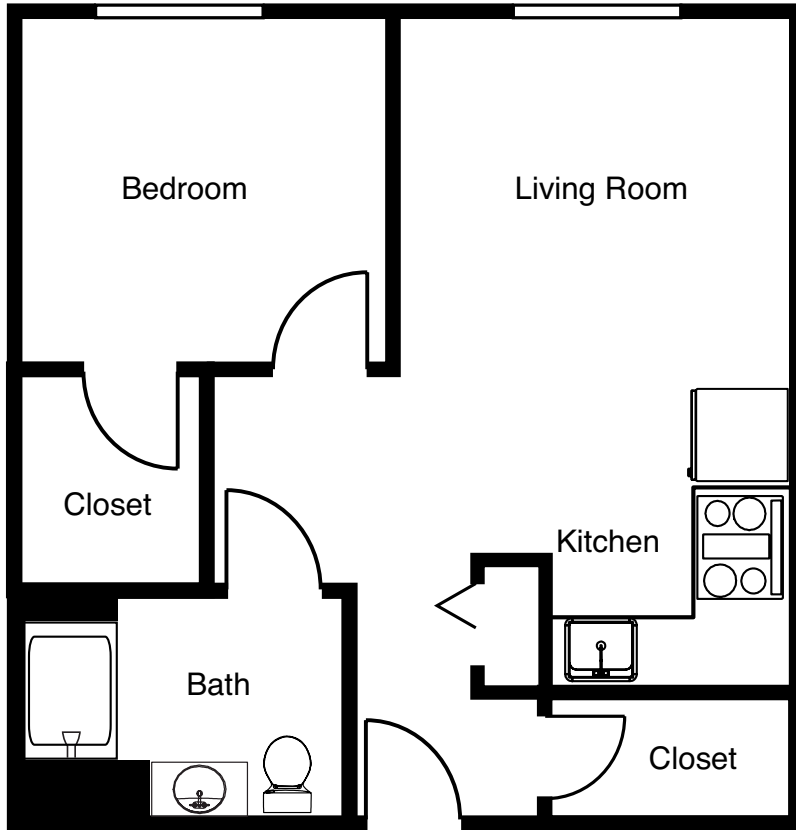

Date _____ Residence # _____ By _____

Community Fee	\$ _____	Monthly Fee	\$ _____
Deposit	\$ _____	2nd Person Fee	\$ _____
Other _____	\$ _____	Other _____	\$ _____
Total \$ _____		Total Monthly Fee \$ _____	

Dimensions are approximate.
 Floor plans may vary.