



119 W. Hayden Lake Road E  
 Champlin, MN 55316  
 (763) 712-0118

ChamplinLIFE@ChamplinSeniorLiving.com

[ChamplinSeniorLiving.com](http://ChamplinSeniorLiving.com)

# Assisted Living One Bedroom A

Approx. 576 sq.ft.

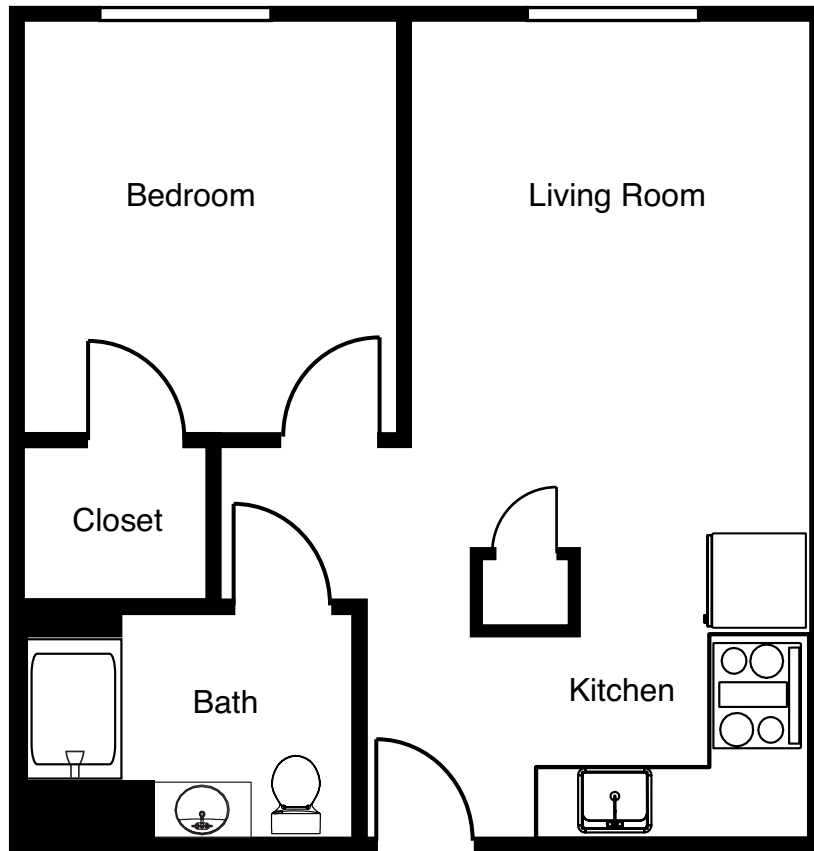

Date \_\_\_\_\_ Residence # \_\_\_\_\_ By \_\_\_\_\_

<b>Community Fee</b>	\$ _____	<b>Monthly Fee</b>	\$ _____
Deposit	\$ _____	2nd Person Fee	\$ _____
Other _____	\$ _____	Other _____	\$ _____
Total \$ _____		Total Monthly Fee \$ _____	

Dimensions are approximate.  
 Floor plans may vary.